

Reversible Truck Guides. Straight Truck Guides.



Technical Description.

Truck guidance systems allow drivers to approach the vehicle to bay in a safe way, preventing any damage to either shelters, bays or to other vehicles.

Technical Characteristics.

- **Length:** 2620mm.
- **Height:** 260 mm.
- **Diameter:** 140mm.
- **Thickness:** 3mm.
- **Guide material:** Galvanised steel S235

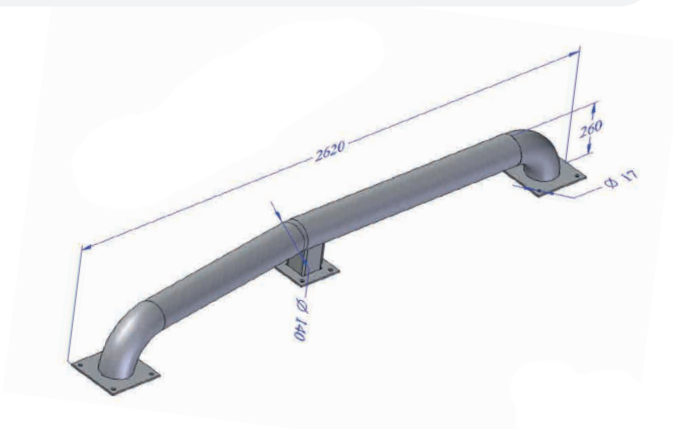

Finishes.

- **Galvanised:** Excellent resistance to corrosion and environmental agents.
- **Painted:** Highly resistant to corrosion and environmental agents
Available colours: Yellow RAL 1003, Black RAL 9005



Fully Galvanised Reversible Lorry Guides.



Reversible Lorry Guides Painted with Stripes.